

## Technical Specifications



## Count Basie Theatre Red Bank, New Jersey

## Count Basie Theatre Technical Specifications



**Count Basie Theatre auditorium as viewed from center stage.**

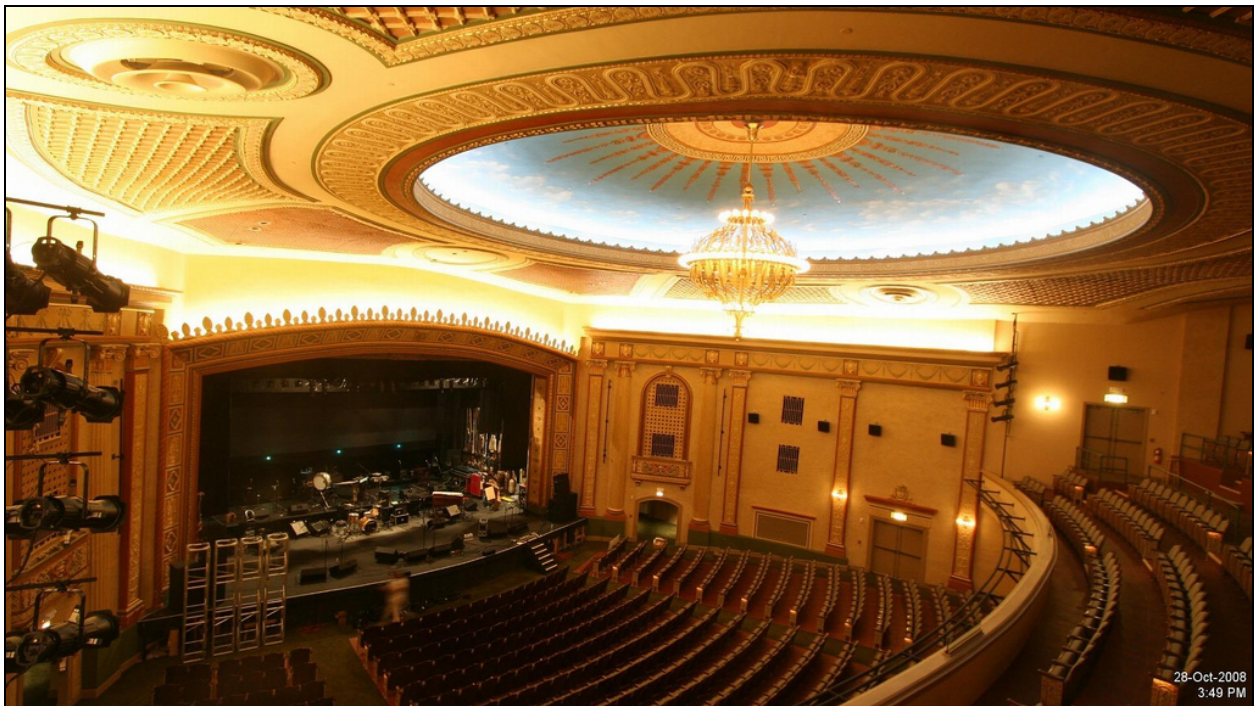

**Count Basie Theatre stage as viewed from the left side of the balcony center aisle.**

**COUNT BASIE THEATRE AWARDS & HONORS**

- 2011: NJ State Council on the Arts Major Presenting Organization Designation
- 2011: NJ Magazine “Best of NJ” edition “Best Live Theatre/Arts Venue”
- 2010: Pollstar Magazine Top 100 Worldwide Theatres
- 2010: Preservation NJ Vision Award
- 2010: NJ State Council on the Arts Major Presenting Organization Designation
- 2009: Pollstar Magazine Top 100 Worldwide Theatres
- 2009: Listed on the NJ State Register of Historic Places
- 2009: Listed on the National Register of Historic Places
- 2009: NJ State Council on the Arts Major Presenting Organization Designation
- 2009: Monmouth County Historical Preservation Commission Award
- 2009: New Jersey Historic Preservation Award
- 2008: Pollstar Magazine Top 100 Worldwide Theatres
- 2008: NJ State Council on the Arts Major Presenting Organization Designation
- 2008: Asbury Park Press Readers’ Choice Award: Best Comedy Venue
- 2008: Asbury Park Press Readers’ Choice Award: Best Community Theater
- 2008: Monmouth County Arts Council Community Champion of the Arts Award
- 2008: Red Bank RiverCenter Special Improvement District Community Partner Award
- 2007: Contribute Magazine Top 200 Investor-Worthy Charities
- 2007: Pollstar Magazine Top 100 Worldwide Theatres
- 2007: Asbury Park Press Readers’ Choice Award: Best Community Theater
- 2007: Eastern Monmouth Area Chamber of Commerce Spinnaker Award
- 2006: Asbury Park Press Readers’ Choice Award: Best Community Theater
- 2006: Asbury Park Press Readers’ Choice Award: Best Place to Listen to Jazz/Blues
- 2006: Asbury Park Press Shore Area Venue of the Year Award
- 2005: Asbury Park Press Readers’ Choice Award: Best Community Theater
- 2001: Asbury Park Press Readers’ Choice Award: Best Community Theater
- 2000: Asbury Park Press Readers’ Choice Award: Best Community Theater
- 1998: Asbury Park Press Readers’ Choice Award: Best Community Theater

**TABLE OF CONTENTS**

<u>Subject</u>	<u>Page</u>
Contact information (address, phone, fax, email).....	4-5
Seating capacity .....	6
Stage dimensions .....	6
Rigging.....	7
Line set schedule.....	9
Miscellaneous equipment.....	9
Orchestra pit.....	9
Drapery .....	9
Power .....	9
Lighting control .....	10
Lighting inventory .....	10
Sound .....	11
Loading and parking .....	11
Dressing rooms .....	11
Motion Picture Projection Equipment .....	12
Local hotel information.....	13
Local music supply stores.....	14
Local emergency and medical information.....	14
Stage ground plan .....	15
House lighting plot.....	16
Seating Plan .....	17
Travel directions (text).....	18
Travel directions (map).....	19
Catering.....	20

## Count Basie Theatre Technical Specifications

### CONTACT INFORMATION

Mailing and shipping address:

Count Basie Theatre  
99 Monmouth Street  
Red Bank, New Jersey 07701

Box Office and Tickets (732) 842-9000

Administrative Office (732) 224-8778

Fax (732) 842-9323

[info@countbasietheatre.org](mailto:info@countbasietheatre.org)

[www.countbasietheatre.org](http://www.countbasietheatre.org)

### STAFF DIRECTORY



Chief Executive Officer .....Numa Saisselin, ext. 105  
[nsaisselin@countbasietheatre.org](mailto:nsaisselin@countbasietheatre.org)

Operations Director.....Izzy Sackowitz, ext. 122  
[isackowitz@countbasietheatre.org](mailto:isackowitz@countbasietheatre.org)

Administrative Assistant.....Ann Marie Keenan, ext. 105  
[admin@countbasietheatre.org](mailto:admin@countbasietheatre.org)

Marketing Director.....Diana St. John, ext. 107  
[dstjohn@countbasietheatre.org](mailto:dstjohn@countbasietheatre.org)

## Count Basie Theatre Technical Specifications

Marketing Multimedia Manager .....	Alycia Yerves, ext. 120 ayerves@countbasietheatre.org
Marketing Assistant .....	Alexandra Campanella, ext. 123 bkelly@countbasietheatre.org
Finance Administrator .....	Peggy Shafai, ext. 108 mshafai@countbasietheatre.org
Finance Assistant .....	Antoinette Koski, ext. 119 akoski@countbasietheatre.org
Technical Director .....	Mike Jacoby, ext. 112 (Cell 732-773-1471) mjacoby@countbasietheatre.org
Artist Catering.....	Laurie Costanzo, cell 732-915-0151 lacbackstage@cs.com
Bar Manager.....	Mike Fitzgerald, ext.105 admin@countbasietheatre.org
Security Supervisor.....	Billy Topps, ext. 105 info@countbasietheatre.org
House Manager .....	Mary Hill, ext. 105 admin@countbasietheatre.org
Facilities Director.....	Chris Lomazzo, ext. 127 clomazzo@countbasietheatre.org
Maintenance.....	Roy McCurdy, ext. 111 info@countbasietheatre.org
Box Office Manager .....	Maryann Wrobel, ext. 101 (private line) mwrobel@countbasietheatre.org
Assistant Box Office Manager.....	Yolande Ruggiero, ext. 101 yruggiero@countbasietheatre.org
Education Director .....	Yvonne Scudieri, ext. 106 <b>ylamb@countbasietheatre.org</b>

## Count Basie Theatre Technical Specifications

### TOUR PRODUCTION NUMBERS

Tour Production Office .....(732) 450-0661 (phone supplied) \*

Tour Production Office .....(732) 842-1998 (no phone supplied)

*The tour production office phone lines are restricted to incoming calls and outgoing local calls. A phone credit card number is needed to make long distance outgoing calls.*

*Wireless Internet is available throughout the building.*

### OTHER LOCAL NUMBERS

Police, Fire, Medical Emergency .....Dial 911

Red Bank Police Department Desk.....1-732-530-2700

Red Bank Fire Marshall .....1-732-530-2760

Riverview Medical Center .....1-732-741-2700

Alcoholics Anonymous Groups of NJ .....1-908-687-8566 or 1-800-245-1377

Narcotics Anonymous of NJ.....1-800-992-0401

Self-Help Clearinghouse .....1-800-367-6274

Psychiatric Crisis Intervention Unit  
Emergency Line (Monmouth County).....1-732-222-3030

### SEATING CAPACITY

Capacity (total fixed seats).....1,568

Orchestra (31 rows).....1,033

Loge (3 rows).....121

Balcony (10 rows).....332

Upper Balcony (3 rows).....70

Orchestra Wheelchair Ramp .....12

### AMERICANS WITH DISABILITIES ACT (ADA) COMPLIANCE INFORMATION

Wheelchair accessible positions .....Orchestra Right Row A Seats 4-6-8  
Orchestra Right Row P Seats 18-20  
Orchestra Right Row Q Seats 18-20

## Count Basie Theatre Technical Specifications

Orchestra Right Row CC Seats 2 & 18  
Orchestra Right Row DD Seats 2 & 14  
Orchestra Center (Right) Row J Seats 101-102  
Orchestra Center (Left) Row J Seats 119-120  
Orchestra Left Row A Seats 3-5-7  
Orchestra Left Row P Seats 17-19  
Orchestra Left Row Q Seats 17-19  
Orchestra Left Row CC Seats 1 & 17  
Orchestra Left Row DD Seats 1 & 13  
Orchestra Wheelchair Platform

Wheelchair accessible bathrooms .....Ground floor by the Women's Room (1)  
Ground Floor in the Carlton Lounge (2)

These 42 fixed and loose chairs can be removed to create 16 wheelchair positions.

Aisle seats with ADA swing away arms.....20 in the orchestra section

### STAGE DIMENSIONS

Proscenium Width.....43 feet 6 inches  
Proscenium Height.....21 feet 3 inches  
Grid Height .....47 feet 6 inches  
Overall Stage Width.....84 feet 3/4 inches  
Stage Right Wing.....29 feet 6 inches  
Stage Left Wing .....4 feet to pin rail, 11 feet to wall  
Stage Depth to Back Wall.....26 feet  
Depth of Orchestra Pit Cover.....10 feet at center, 6 feet at sides  
Stage Depth to Back Wall with Pit Cover .....36 feet at center, 32 feet at sides  
Curtain Line to Last Line .....24 feet 6 inches  
Stage Surface .....Black masonite  
Stage Construction .....Sprung up to one-half inch, no rake, no wax  
Dance Floor.....Black Marley available in-house  
Traps .....Two stage floor traps, block and fall may be rigged  
for transfer to basement.

### ORCHESTRA PIT DIMENSIONS

Capacity .....20 comfortably  
Width.....34 feet 2 inches  
Depth.....8 feet 3 inches  
Access .....through Green Room under stage

### RIGGING SPECIFICATIONS

Total Battens .....26 hemp lines

## Count Basie Theatre Technical Specifications

Empty and available.....	11 battens
Available when house soft goods are struck..	20 battens
Never available .....	2 battens (Fire Curtain, House Curtain)
Pin rail location .....	Stage left at stage level
2nd pin rail location .....	Fly gallery on the 4th floor
Distance between line sets .....	See attached line set schedule
Pipe length .....	52 feet
Sandbags .....	2 @ 200 lbs.
	5 @ 100 lbs.
	10 @ 50 lbs.
	12 @ 25 lbs.
	12 @ 10 lbs.
Block and Tackle Sets.....	2 @ 3x2
FOH Truss.....	4 @ 10'x20.5"x20.5" truss with bolts
Chain Hoist .....	2 CM 1-ton motors
	1 Rigstar 1-ton motor
	All motors used on FOH lighting truss
Motor Control .....	Skjonberg 8 Chain Motor Controller
Motor Cable .....	1 @ 75 feet
Span Sets.....	6 @ 6 feet, 3 @ 3 feet

### LINE SET SCHEDULE

Grid Height .....47 feet 0 inches

All four (4) electrics have attached cable and can fly out to 29 feet.

Number / Description / Distance from Proscenium

1	Fire Curtain (not available for any other purpose) .....	0 feet 9 inches
2	House Curtain (not available for any other purpose).....	1 feet 2 inches
3	1st Border (available) .....	1 feet 9 inches
4	1st Legs (available).....	2 feet 3 inches
5	Available.....	3 feet 0 inches
6	1st Electric (available) .....	3 feet 6 inches
7	Available.....	5 feet 4 inches
8	2nd Border (available) .....	7 feet 5 inches
9	2nd Legs (available) .....	7 feet 9 inches
10	2nd Electric (available).....	8 feet 9 inches
11	Available.....	10 feet 3 inches
12	Available.....	10 feet 11 inches
13	3rd Border (available).....	12 feet 9 inches
14	3rd Legs (available) .....	13 feet 5 inches
15	Available.....	14 feet 3 inches
16	Available.....	15 feet 0 inches
17	3rd Electric (available) .....	16 feet 6 inches

## Count Basie Theatre Technical Specifications

18 Available.....	18 feet 2 inches
19 4th Border (available).....	18 feet 10 inches
20 4th Legs (available).....	19 feet 10 inches
21 Available.....	21 feet 3 inches
22 4th Electric (available).....	22 feet 8 inches
23 Available.....	
24 Available.....	
25 Available.....	
26 Black Out Curtain (available).....	25 feet 6 inches

### DRAPERY & SOFT GOODS INVENTORY

House Curtain .....	Hunter Green Velour with split center opening, opens vertical
House curtain rope location .....	Stage left
Sets of Legs.....	4 sets of black velour legs
Legs Dimensions.....	23 feet high, 12 feet wide
Sets of Borders.....	4 black velour borders
Border Dimensions .....	48 feet wide, 12 feet high
Back Drop .....	Black Velour
Back Drop Dimensions .....	50 feet wide, 23 feet high
Mid-Stage Black .....	Black Velour
Mid-Stage Black Dimensions .....	50 feet wide, 23 feet high
Black Scrim.....	1 @ 50 feet wide, 23 feet high
White Scrim .....	1 @ 50 feet wide, 23 feet high
White Cyclorama .....	1 @ 50 feet wide, 23 feet high

### MISCELLANEOUS EQUIPMENT INVENTORY

Step Ladders.....	1 @ 16 feet 1 @ 12 feet 1 @ 10 feet 1 @ 8 feet 1 @ 6 feet
Paper Cutter .....	1
Saws .....	1 7-1/4 Craftsman Radial Arm Saw 1 Delta 10" Table Saw 1 Sawzall
Compressor .....	1 Cadman 20 gallon compressor with 100' hose
Personnel Lift.....	Genie AWP™ 36 Super Series™ Lift. Working height @ 42 ft. 5 in.

### COMMUNICATIONS

Base Station .....	Clear-Com 2 channel
Cable .....	2 @ 20 feet 4 pin (Cannon)

## Count Basie Theatre Technical Specifications

Belt packs.....	9 Clear-Com 501 Belt packs
Headsets .....	12 Clear-Com Headsets
Permanent Stations.....	Stage Left Stage Right FOH Sound Mix Position FOH Lighting Control Position FOH Video Projection Position 4 Follow Spot Positions

### ELECTRICAL POWER

Lighting.....	400 Amps 3-Phase located stage right
Sound .....	100 Amps 3-Phase located stage left

### LIGHTING CONTROL

Dimmer Packs.....	1 ETC/LMI L86 Dimmer Rack 1 ETC Sensor 24 x 2.4KW Dimmer Rack
Total Dimmers .....	120 @ 2.4K
Patch Location .....	Located stage right
Dimmers 1-24 .....	Hired wired 1-12 @ Balcony Booms 13-24 @ Balcony Rail
Dimmers 25-96 .....	Available
ETC Sensor Rack Dimmers 1-24.....	Available
Splitter.....	1 Doug Fleenor 125EE-5 output Enhanced <sup>2</sup> Isolated Splitter
Control .....	ETC ION 2048 outputs w/ Universal Fader Wing (40 Faders)
Control Monitors.....	2 high-resolution Flat Screens
Control Location.....	90 feet from the stage in the rear orchestra

### LIGHTING INVENTORY

Follow Spots .....	2 Lycian Superstar 1.2kw with Metal Halide Lamp
Follow Spot Location.....	110 foot throw from booth at rear of balcony
ETC 36deg Source Four.....	30
ETC 26deg Source Four.....	60
ETC 14deg Source Four.....	16
ETC Source Four Par .....	60
Par Can 64.....	12
4 Light Mole Fay Audience Blinder .....	3
ACL Bars .....	6
Martin Mac 575 Krypton Spot Moving Light.....	6
Martin Mac 600 Wash Moving Light .....	6

## Count Basie Theatre Technical Specifications

DF-50 Hazer.....	1
15-Lamp 8 foot R40 Flood Fixtures .....	4
Source 4 Par Lens Kits (Wide, Medium, Narrow, Very Narrow) .....	60
Par 64 Wide Flood 1K Lamps .....	12
Par 64 Medium Flood 1K Lamps.....	12
Par 64 Narrow Flood 1K Lamps.....	12
Par 64 Very Narrow Flood 1K Lamps.....	12
HPL 575W Spare Lamps .....	24
HPL 750W Spare Lamps .....	24

### LIGHTING CABLE INVENTORY

100 Foot Stage Pin Cable.....	6
50 Foot Stage Pin Cable.....	4
20 Foot Stage Pin Cable.....	20
10 Foot Stage Pin Cable.....	22
5 Foot Stage Pin Cable.....	30
Stage Pin Twofers .....	60
Male Stage Pin to Female Edison Adaptor ....	12
Female Stage Pin to Male Edison Adaptor ....	12
12-Circuit Multi Cable .....	3 @ 125 feet
6-Circuit Socopex Cable .....	1 @ 50ft, 1 @ 75ft
L6-20 breakouts – staggered.....	2
L6-20 100' jumpers .....	3
L6-20 25' jumpers .....	3
L6-20 Twofers .....	3

### LIGHTING ACCESSORIES INVENTORY

Boom Bases .....	8
Boom Base Pipes .....	8 @ 12 feet, 6 @ 8 feet
Side Arms.....	56
Sliding T's.....	56
ETC Source Four Iris .....	4
ETC Source Four Color Extenders .....	12
ETC Source Four Top Hats.....	12
Altman 7 ½ inch Top Hats.....	12
ETC Source Four 6 ½ inch Gel Frames.....	100
ETC Source Four Par Frames .....	120
Altman 7 ½ inch Gel Frames .....	48
Par 64 Gel Frames.....	128
ETC Source Four 6 ½ inch Doughnuts.....	12
ETC Source Four Gobo Frames.....	30 @ A-Size, 30 @ B-Size, 6 @ Glass
Altman Gobo Frames .....	22
Safety Cables .....	108

## SOUND EQUIPMENT INVENTORY

This inventory describes the sound equipment available in-house. The Count Basie Theatre's resident sound company is ACIR Professional, 6677 Blackhorse Pike - Suite B, Egg Harbor Township, NJ 08234, phone 609-677-5500, fax: 609-677-5501, www.acirpro.com.

Mix Position.....	90 feet from the stage in the rear orchestra
Consoles and Mixers.....	Mackie 32x8x2 console Biamp Advantage 8 Channel Biamp Mic Mixer Biamp Auxiliary Mixer
Amplifiers .....	Crown K2, QSC USA 850, Bogen MTA 125A
Outboard Gear.....	TOA D-113 Digital Delay Yamaha REV 500 Digital Reverb DBX 3031 Graphic EQ DBX 3215 Graphic EQ PreSonus ACP-8 Compressor/Limiter/Gate
Microphones .....	4 Shure SM58 3 Shure SM57 5 Crown PCC160 2 AKG SE 300B 2 AKG CK 98
Microphone Stands .....	8 AKG Tripod 2 straight stands with round bases
Speakers .....	4 EV SX200 12x4
Monitors.....	
XLR Cables.....	2 @ 10 feet, 10 @ 20 feet, 2 @ 100 feet
Compact Disc Player .....	1 JVC XLV161 compact disc player
Cassette Tape Player.....	1 JVC TDW317 cassette tape player

## DRESSING ROOMS

Total Dressing Rooms.....	8 private dressing rooms
Access and Location .....	Tower located stage left
Floors in the Dressing Room Tower.....	4 (1st floor is stage level)
Dressing Rooms Per Floor .....	2
Capacity .....	4 persons per room comfortably
Sinks.....	One sink per room
Showers.....	Two, one in each 2nd floor dressing room
Toilets .....	One toilet per floor
Green Room .....	1 large room located below stage

## LOCAL MUSIC SUPPLY STORES

Monmouth Music

## Count Basie Theatre Technical Specifications

30 Monmouth Street  
Red Bank, New Jersey 07701  
(732) 747-8888

Walking time: one block from the Count Basie Theatre.

Jack's Music  
30 Broad Street  
Red Bank, New Jersey 07701  
(732) 842-0731

Walking time: four blocks from the Count Basie Theatre.

### **BACKLINE INVENTORY**

This is the inventory of musical instruments, amplifiers and equipment available in-house. Additional backline is available from the Count Basie Theatre's resident sound company.

#### Yamaha Custom Maple Drum Kit with Zildjian "A" Cymbal Set

- 22" bass drum
- 10" rack tom
- 12" rack tom
- 16" floor tom
- 14" snare
- 14" "New Beats" hi hats
- 10" splash
- 16" crash
- 18" crash
- 20" ride

#### Keyboards

- 7' Kanabe piano
- Kurzweil PC 1-X

#### Miscellaneous

- 4 guitar stands

### **Motion Picture Projection Equipment**

- 2 Simplex XL projectors (manufactured circa 1955) fully restored, equipped with:
  - Dolby digital penthouse readers
  - Kelmar reverse scan LED analogue readers

## Count Basie Theatre Technical Specifications

- Peerless Magnarc carbon arc lamps
- Picture and sound changeovers
- Sound Rack equipped with:
  - Dolby CP650
  - DCM-3 monitor
  - 2 QSC DCA 1622 2 channel amplifiers
  - 5 QSC DCA 3022 2 channel amplifiers
  - 2 QSC DCA 1842 4 channel amplifiers
  - Digital CD player
- Speaker System
  - 3 JBL 4632-T stage speakers (left-center-right array/tri amped)
  - 2 JBL 4642A subwoofers
  - 20 JBL 8340A surround speakers
- Stage Screen
  - Hurley microperf , permanently mounted on frame on fly
  - Throw from projectors to screen 119 feet
  - Screen size 17 feet 6 inches high x 40 feet wide
  - Scope image approx. 16x37 1/2ft.
  - Flat image approx. 16x29 1/2ft.

### HOTEL INFORMATION

The following lodging establishments have been supportive of the Count Basie Theatre, and are recommended. Make sure to mention that you are playing the Count Basie Theatre, and ask for the theatre's corporate rate.

#### **Blue Bay Inn**

## Count Basie Theatre Technical Specifications

51 First Avenue, Atlantic Highlands, NJ 07716  
Phone 732-708-9600, Fax 732-291-2119  
[www.bluebayinn.com](http://www.bluebayinn.com)

Distance: 7.3 miles. Drive time: 16 minutes.

The Blue Bay Inn is the only boutique hotel on the Jersey shore. Ideally located in the heart of downtown Atlantic Highlands, the Blue Bay Inn is the perfect place to indulge your desires. Within 2 blocks, there are 12 restaurants, a movie theatre, upscale boutiques, spas, artisan shops, a coffee house and the Seastreak ferry which luxuriously shuttles back and forth to Manhattan in 35 minutes.

### **Courtyard by Marriott**

245 Half Mile Road, Red Bank, NJ 07701  
Phone 732-530-5552, Fax 732-530-5756  
[www.redbankcourtyard.com](http://www.redbankcourtyard.com)

Distance: 2.0 miles. Drive time: 5 minutes.

The Red Bank/Lincroft Courtyard by Marriott is located at exit 109 off the Garden State Parkway. Experience their newly renovated guest rooms, featuring new bedding and pillows, a large well-lit desk, ergonomic chair and free high-speed Internet access. Courtyard by Marriott offers an exercise room, whirlpool, indoor pool, and the Courtyard Cafe.

### **Holiday Inn**

700 Hope Road, Tinton Falls, NJ 07724  
Phone 732-544-9300, Fax 732-544-0570  
[www.hitintonfalls.com](http://www.hitintonfalls.com)

Distance: 6.5 miles. Drive time: 11 minutes.

The Holiday Inn Tinton Falls is conveniently located just off the Garden State Parkway exit 105, minutes from the Shore's beaches, boardwalks, racetrack, and mall. It features an outdoor pool, game room, 24hr fitness room, gift shop and the restaurant/lounge Morgans. The hotel has free high-speed wireless access, and pets are welcome, with a \$50 non-refundable pet fee at check in.

### **Molly Pitcher Inn**

88 Riverside Avenue, Red Bank, New Jersey 07701  
Phone 732-747-2500 ext. 579, Fax 732-842-8289  
[www.mollypitcher-oysterpoint.com](http://www.mollypitcher-oysterpoint.com)

Distance: 0.3 miles. Drive time: 1 minute.

The Molly Pitcher Inn is one of America's most charming waterfront, full service hotels. Nestled on the shores of the Navesink River in Red Bank, NJ, the inn offers extraordinary water views, fine dining and luxurious accommodations. The hotel is only minutes away from the Count

## Count Basie Theatre Technical Specifications

Basie Theatre, restaurants, antique shops, bars, and lounges. The property offers 106 guest rooms including suites, 10 meeting rooms, an outdoor pool, fitness center, docking marina, and high-speed wireless Internet.

### **Oyster Point Hotel**

88 Riverside Avenue, Red Bank, New Jersey 07701  
Phone 732-747-2500 ext. 579, Fax 732-747-1875  
www.mollypitcher-oysterpoint.com

Distance: 0.6 miles. Drive time: 2 minutes.

The Oyster Point Hotel is the contemporary sister property of the Molly Pitcher Inn. The hotel is only 5 minutes from the Count Basie Theatre, within walking distance of the town's boutiques, restaurants, antique shops, parks and lounges. This property features 58 deluxe guest rooms including suites, complimentary fitness center, marina, and high-speed wireless Internet, excellent cuisine, and the finest service.

### **Sunrise Suites Hotel**

3 Centre Plaza, Tinton Falls, NJ 07724  
Phone 732-389-4800, Fax 732-389-0137  
olgasunrisesuites@yahoo.com

Distance: 6.7 miles. Drive time: 12 minutes.

Sunrise Suites is an all suites hotel featuring complimentary breakfast, indoor swimming pool, running track, game room and sauna. Conveniently located off the Garden State Parkway at exit 105, the Sunrise Suites also features meeting and banquet space. Please contact us direct for reservations at 732.389.4800.

## LOADING & PARKING INFORMATION

Loading Dock Location .....	Pearl Street behind the Phoenix Productions building.
Vehicle Space at Loading Dock.....	Space for 1 tractor trailer or 1 tour bus.
Loading Door Dimensions.....	6 feet wide, 10 feet high.
Loading Door Elevation.....	Street level, 4 feet above stage level.
From Street to Stage.....	12 foot truck ramp already in place.
Other Parking .....	Can be arranged.
Shore power .....	Shore power available for one vehicle.

\* Please note that by municipal ordinance, the Borough of Red Bank, NJ prohibits the continual running or idling of bus engines and motors!

**Count Basie Theatre Stage Plan – 2010**

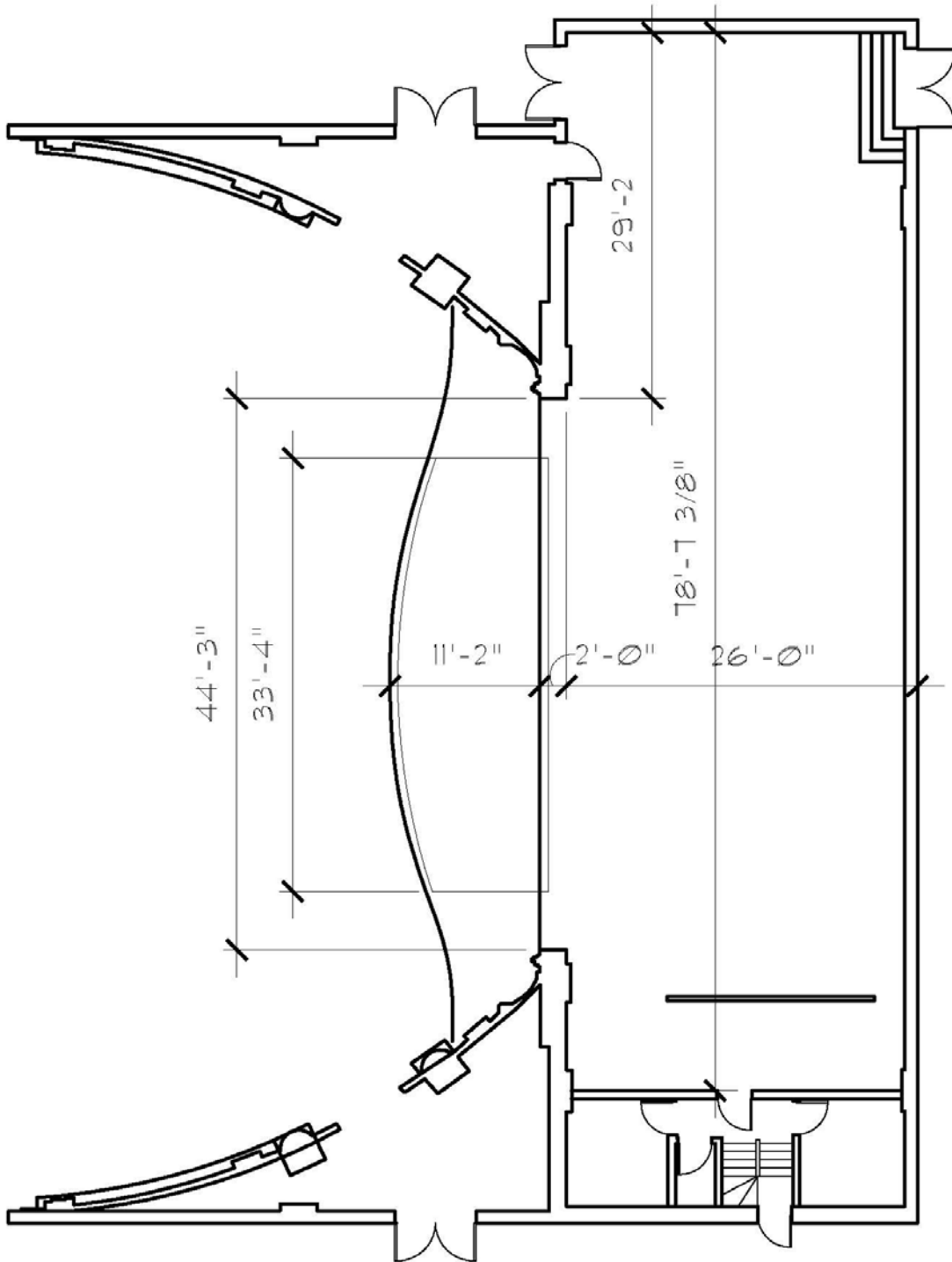

**Count Basie Theatre Cross Section – 2010**

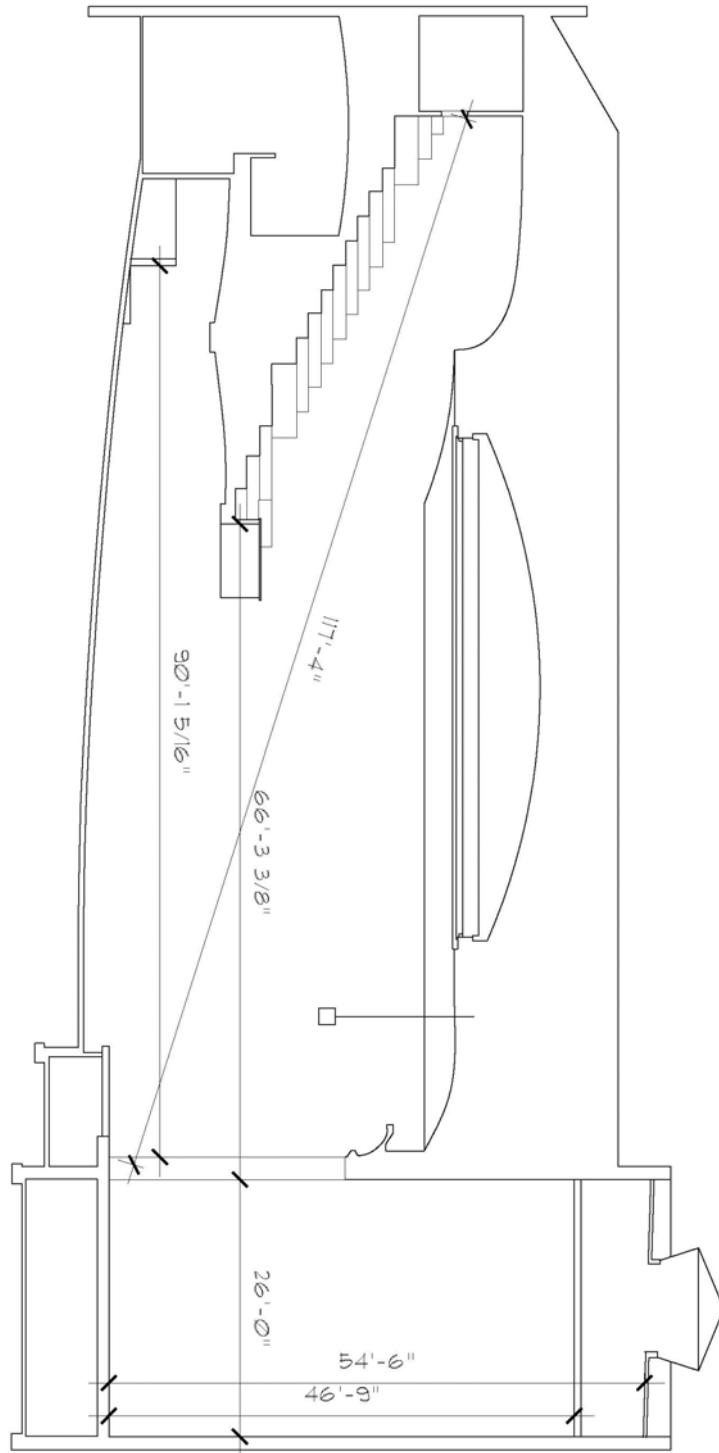



**Count Basie Theatre Seating Chart - 2010**

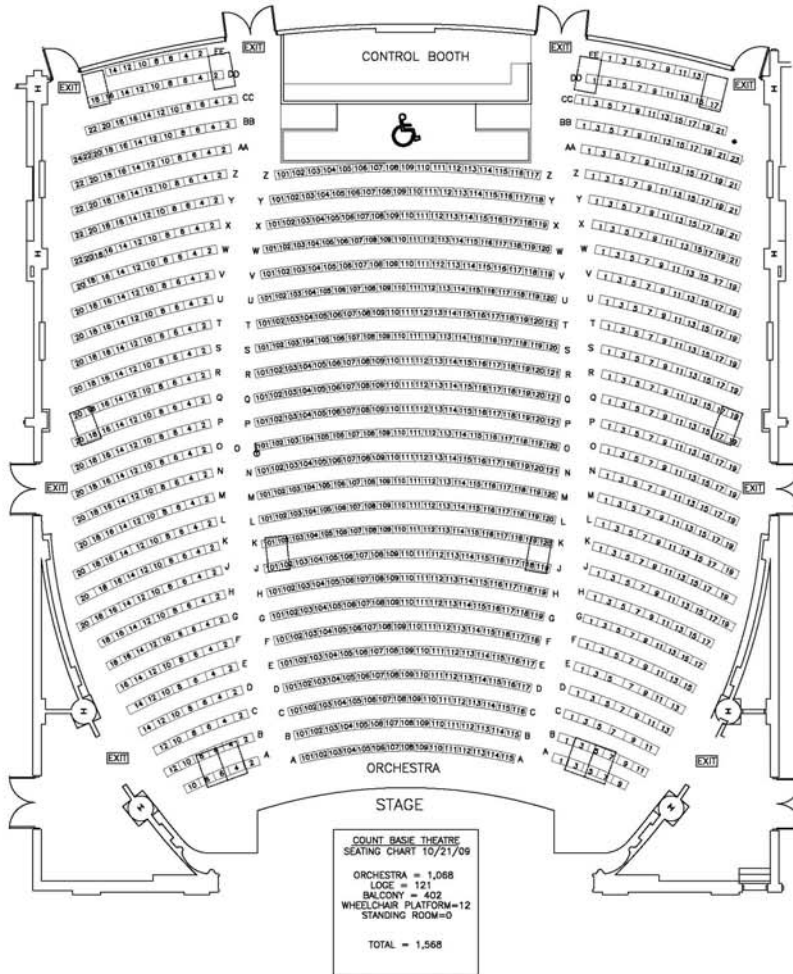
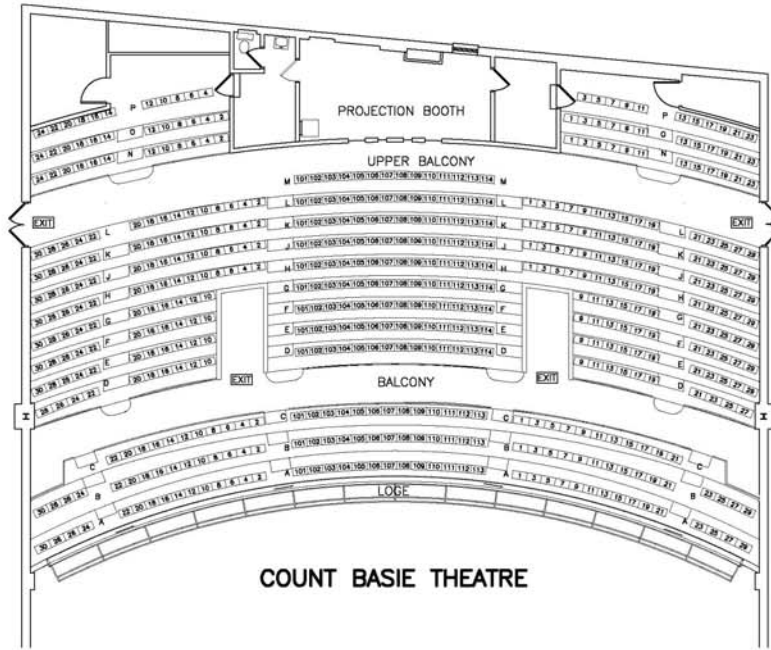

## TRAVEL DIRECTIONS

**VIA TRAIN:** The Count Basie Theatre is an easy five-minute walk up Monmouth Street from the Red Bank train station. Take the NJ Transit North Jersey Coast Line to Red Bank from New York City Penn Station, or from Newark Penn Station, or from Newark Airport. You can connect to Amtrak at New York Penn Station or Newark Penn Station. Travel time on the train from NYC is about one hour and ten minutes. For NJ Transit schedule information, visit [www.njtransit.com](http://www.njtransit.com).

### **TRUCKS: COMMERCIAL VEHICLES ARE PROHIBITED ON THE GARDEN STATE PARKWAY. FOLLOW THE ROUTE 35 DIRECTIONS.**

#### **BY CAR FROM THE SOUTH**

**FROM THE SOUTH VIA THE GARDEN STATE PARKWAY:** Take Exit 109 for Red Bank and Lincroft. After the toll booth bear left to the light at Newman Springs Road. Drive straight through the light for Half Mile Road. Take Half Mile Road to its end and make a right onto West Front Street. Take West Front Street to the second light and make a right onto Shrewsbury Avenue. Take Shrewsbury Avenue for one block and make the first left onto Monmouth Street. The Count Basie Theatre is a few blocks up on the right side.

**FROM THE SOUTH VIA ROUTE 35:** Take Route 35 north toward Red Bank. At the intersection of Newman Springs Road/County Road 520, cross the train tracks and stay straight for Broad Street in Red Bank. Take Broad Street to the third traffic light and make a left onto Monmouth Street. Take Monmouth Street for one long block and through the light at Maple Avenue. The Count Basie Theatre is on your left just past Maple Avenue.

#### **BY CAR FROM THE NORTH**

**FROM THE NORTH VIA THE GARDEN STATE PARKWAY:** Take Exit 109 for Red Bank and Lincroft. After the toll booth make a left at the light onto Newman Springs Road. Just after the second highway overpass make a sharp right onto a “U Turn” ramp. Bear left at the end of the “U Turn” ramp to a light. Drive straight through the light for Half Mile Road. Take Half Mile Road to its end and make a right onto West Front Street. Take West Front Street to the second light and make a right onto Shrewsbury Avenue. Take Shrewsbury Avenue for one block and make the first left onto Monmouth Street. The Count Basie Theatre is a few blocks up on the right side.

**FROM THE NORTH VIA ROUTE 35:** Take Route 35 South toward Red Bank. After crossing the Navesink River, make a left at the first light. Drive straight at the second light. Drive straight at the third light. One block after the third light Route 35 makes a sharp left - stay straight for Pearl Street. One block on Pearl Street, and make a left onto Monmouth Street. The theatre is on your right.

**PARKING:** There is plenty of street parking in Red Bank. However, on a show night, especially a Friday or Saturday night, parking downtown can be problematic. If you need to secure a

## Count Basie Theatre Technical Specifications

parking space close to the theatre, we strongly suggest arriving *earlier* than one-half hour before show time. The White Street municipal parking lot is located in the block bounded by Monmouth Street, Broad Street, White Street and Maple Avenue. Your best bet is to park at the Red Bank Train Station and walk back up Monmouth Street to the Basie. Parking for the disabled is available in the parking lot of the Red Bank Municipal Building, across Monmouth Street from the Basie.



**Directions to the Count Basie Theatre**

99 Monmouth Street, Red Bank, New Jersey 07701  
Box Office (732) 842-9000

**From the Garden State Parkway**

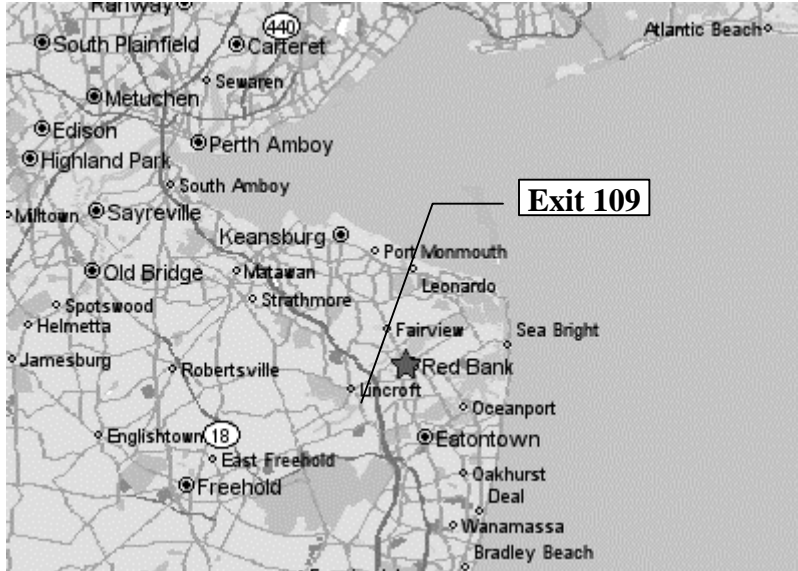

**Loading Doors: back into side of building off Pearl Street. Big red doors behind Phoenix Productions building.**

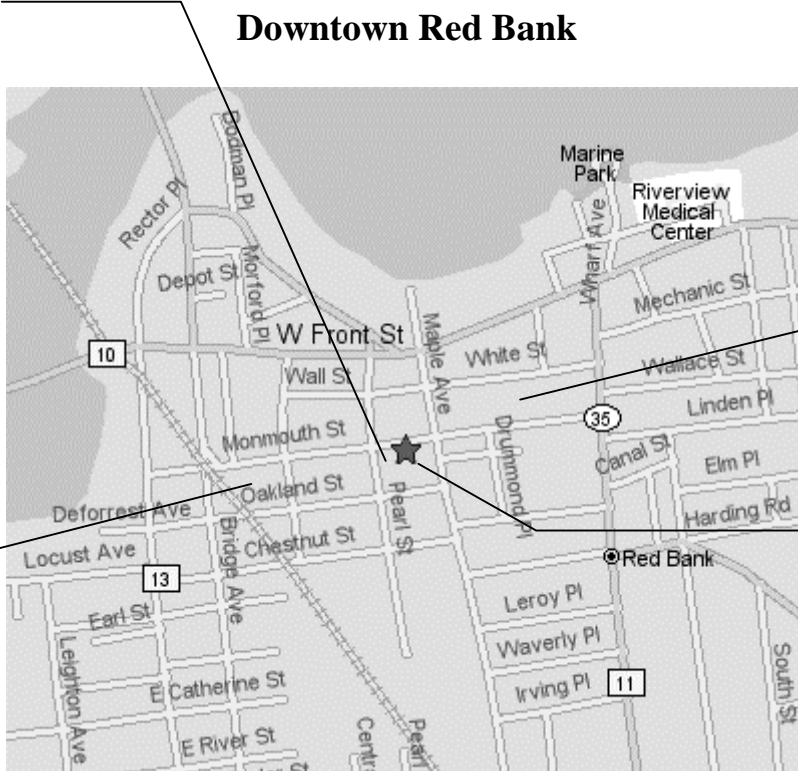

**Municipal Parking Lot**

**Parking available here at the Red Bank Train Station**



## BACKSTAGE CATERING INFORMATION

While you are in our house, the Count Basie Theatre, Inc. will gladly provide its artists and crew with quality meals and beverages. The CEO's Italian/Jewish mother would be very upset if we didn't feed everyone well. However, the Count Basie Theatre, Inc. is a nonprofit organization managing and trying to restore a 75 year old historic theatre. It can not afford to fuel an entire tour. Therefore, we will not stock the buses, nor rush around madly making arrangements for personnel above and beyond the artists and tour personnel that we have been told to expect, nor make runs for additional food or beverages from local restaurants should someone have a sudden craving. Catering is also provided for the local crew, and all meals are served buffet style in the Green Room area beneath the stage. We can prepare plates to bring to individual dressing rooms, but because of the size and placement of the backstage area and dressing rooms, separate facilities for private meals are not possible. The catering staff is on premises all day. The theatre's standard catering provisions:

### ALL DAY

Hot coffee  
Hot water  
Milk - whole, 2%, skim, flavored, chocolate and Half and Half  
Lemons and honey  
Sugar, Sweet & Low, Equal  
Bottled Spring Water  
Fresh brewed iced tea  
Hot chocolate  
Assorted sodas and juices  
Clean ice for drinks

### BREAKFAST

(for load-ins starting before 9:00 a.m.)

Assorted breads for toasting  
Assorted bagels and donuts  
Croissants  
Waffles  
Assorted jams and jellies  
Butter and cream cheese  
Assorted cereals - hot and cold  
Assorted nutigrain and granola bars  
Assorted yogurt  
Fresh fruit

### LUNCH

A selection of the following:

Deli platter with quality meats/cheeses  
Lettuce/tomato/onion platter  
Assorted salads-potato, pasta, cole slaw, wasabi, etc.  
Tea - regular and herbal  
Assorted breads and rolls  
Macaroni and Cheese  
Hot Dogs  
Fried Chicken  
Sloppy Joes  
Grilled Cheese always available and made to order  
Hot soup  
Mustard, mayonnaise, ketchup, horseradish sauce  
Fresh fruit  
Yogurt  
Assorted chips, pretzels, nuts, candy and snacks

### DINNER

Fresh green salad with assorted dressings  
One hot beef or pork entree  
One hot chicken entree  
One hot fish or vegetarian entree  
Hot potatoes or rice  
Two hot fresh vegetables  
Fresh dinner rolls or French bread  
Assorted desserts - cakes, pies, pastries

All dining and serving tables are covered with fresh clean cloths. Plastic cutlery provided for breakfast and lunch. China and stainless steel cutlery provided at dinner. Catering staff always in the house.

## Count Basie Theatre Technical Specifications



The Count Basie Theatre circa 1950, then privately owned by Walter Reade.

[End of Document]